

BASIC INFORMATION

/// VENUE

| | |
|---------------------------|--|
| absolute room size | width 20m depth 12,5m height var. |
| capacity | standing: 180 people seated: 120 people |
| stage | 5m x 4m x 0,6m (w x d x h) clearance 3,5m |
| merch fee | - |

/// BACKSTAGE

| | |
|--------------------------|--|
| lounge | 20m ² fridge, sofa, table & chairs, mirror, water, free WiFi |
| kitchen | - |
| production office | - |
| toilets | - |
| showers | - |

/// PARK & LOAD

| | |
|-------------------------|---|
| parking | please use the parking lot „Kaufland“ for free parking we need the licence plate of your car in advance |
| loading | about 15m – stage lower than ground level (stairs) |
| nightliner power | 32A 3ph. CEE |

/// FLOOR PLAN

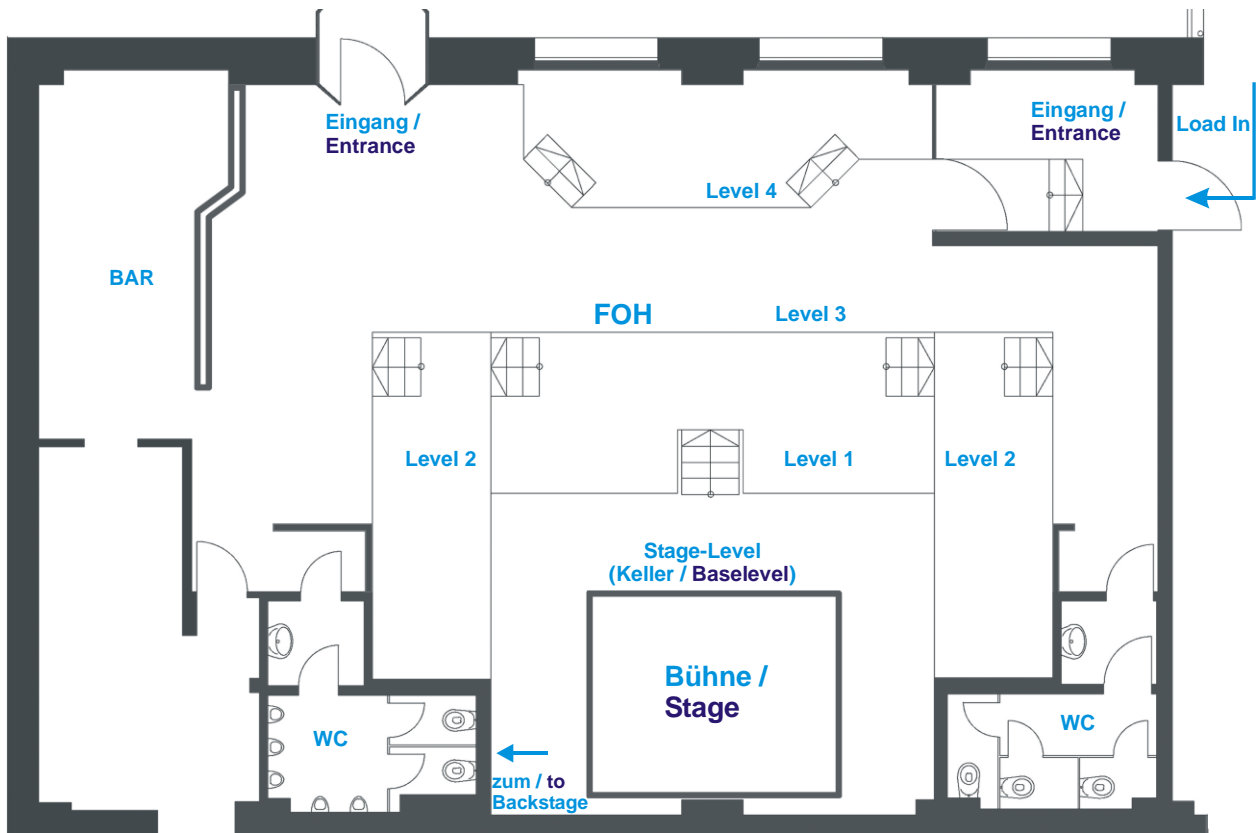

TECHNICAL INFORMATION

/// SOUND

To provide the best possible concert-experience for our audience we would like to request that the average sound-pressure-level during the show is maximum 99db(A) at the front of house.

main-PA speaker Seeburg acoustic line
 02x K-24
 02x K-sub 1801
 03x TT Nano (Outfill)

main-PA amps 01x Crown Xti 1002
 02x Crown Xti 6002

/// VENUE SHEET – KELLERBÜHNE



KULTURZENTRUM
E-WERK
Erlangen

| | |
|---------------------------------|--|
| main-PA signal | PA via left-right Analog (XLR) |
| FOH desk | 01x Allen & Heath SQ5 incl. Dante Card <i>on request: Allen & Heath SQ7</i> |
| stagebox | 01x Allen & Heath DT168 |
| monitor desk | - There are solid walls left & right of the stage, so there is no space for a separate monitor desk! |
| monitoring speaker | 04x d&b MAX12 |
| monitoring amps | 01x the t.amp TSA 4-700 |
| multicore system | 04x CAT 6a 32/08 analog |
| microphones | Shure SM58, SM57, Beat52A, Beta91A, SM81 Sennheiser e606, e604 Oktava MK012, MK219 BSS AR133 <i>other microphones on request</i> |
| stands | 01x K&M bassdrum-stand, ultra-small, heavy 10x K&M stand tall 08x K&M stand small |
| power supply sound stage | 01x 16A Schuko, 1ph |
| power supply sound FOH | 01x 16A Schuko, 1ph |

/// LIGHTING

| | |
|---------------------|---|
| stage lights | 05x Expolite TourLED 21 04x Expolite TourLED 42 02x Fresnel |
| front lights | 02x Arri ST1 p.o. 02x StudioPar64 RGB |
| side lights | - |
| haze / smoke | no haze or smoke allowed! |

/// VENUE SHEET – KELLERBÜHNE



KULTURZENTRUM
E-WERK
Erlangen

**dancefloor lights
(disco only)** 04x ADJ Revo 4

house lights ERCO-LED system, not dimmable via DMX

lighting desk Showtec easy fade 36

DMX universe 1 universe

dimming system Ultralite
12x10A dimmer channels

**power supply lights
stage** 01x 32A CEE, 3ph
01x 16A Schuko, 1ph

**power supply lights
FOH** -

/// VIDEO

projector 01x Panasonic PT-DZ680
6000 ANSI, WUXGA (1900x1200)
Input HDMI

screen 01x ceiling-installed motorscreen 6x3,5m



CONTACT

/// VENUE

address E-Werk Kulturzentrum GmbH
Fuchsenwiese 1
91054 Erlangen
Germany

phone +49 (0)9131 8005 0

fax +49 (0)9131 8005 10

mail info@e-werk.de

/// DEPARTMENTS

booking Holger Watzka
holger.watzka@e-werk.de
+49 (0)9131 8005 54

venue rental Johanna Sachse
johanna.sachse@e-werk.de
+49 (0)9131 8005 14

house technic Andreas Drechsler
andreas.drechsler@e-werk.de
+49 (0)9131 8005 57

event technology Sebastian Simons
sebastian.simons@e-werk.de
+49 (0)9131 8005 20